

Ceiling Fan LK122 Installation Instructions

WARNING

Turning off wall switch is not sufficient. To avoid possible electrical shock, be sure electricity is turned off at the main fuse box before removing, installing, or servicing the light fixture.

CAUTION

All fitters/light kits must only be used with ceiling fans. Do NOT install as a lighting fixture attached to building structure!

NOTE: These instructions are intended to cover various fan models (Americana, Brewmaster [on motor], Islander, Louvre, Palisade, Sandella, Treventi & Tropicana).

1. Remove the switch housing from the fan by unscrewing the housing screws and unplugging the connector (Figures 1 & 2).
2. Remove the threaded plug, lockwasher, and nut from the center of this cover by unscrewing it. You may discard or keep them for future use (Figure 3).
3. Attach the switch housing to the fitter/light kit by feeding the wires (black & white) through the hole of the switch housing, place lockwasher over the fitter/light kit leads & nipple and fasten the fitter/light kit with the nut provided onto the nipple. Be sure it is tight enough to prevent fitter/light kit from vibrating loose (Figure 4).
4. Locate two single wires in switch housing. White (gray on some models) and blue (red on some models) labeled "FOR LIGHT" (Figure 3).
5. Connect them to the fitter/light kit wires (Figure 4);
 - White (gray) to white
 - Blue (red) to black
6. Carefully reconnect the connector and push all wires back into switch housing of fan. Then replace cover with original screws. (Figure 5-various fan models) (Figure 6-Sandella model) (Figure 7-Treventi model)
7. Install appropriate bulbs (not provided). Install glass bowl (while supporting the bowl) by attaching the rubber washer and the hex nut. Install the bowl cap and the final nut onto the center of the light kit (Figure 8).
8. Restore the power and your light kit is ready for operation.

WARNING

Check to see that all connections are tight. To avoid possible electrical shock, make sure that the electrical wires are completely inside the switch housing and not pinched between the switch cap base and switch housing.

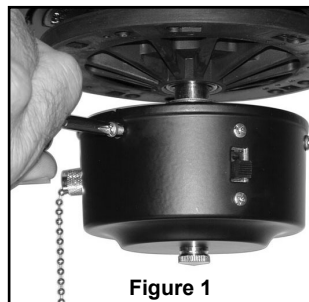

Figure 1

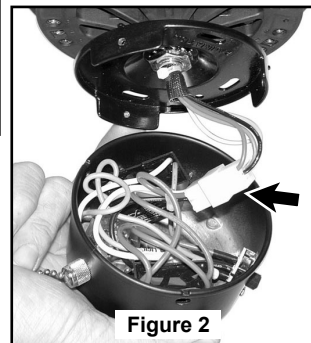

Figure 2

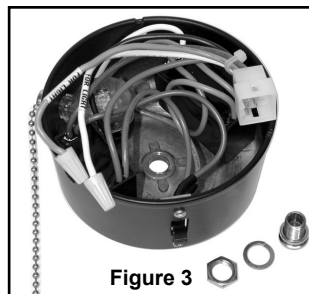

Figure 3

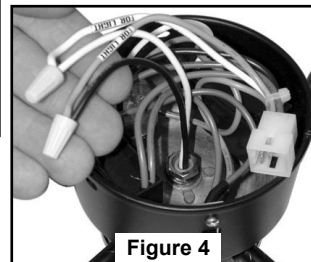

Figure 4

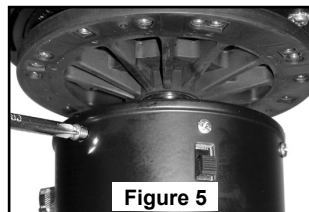

Figure 5

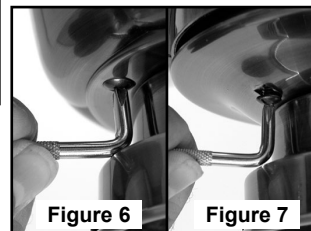

Figure 6

Figure 7

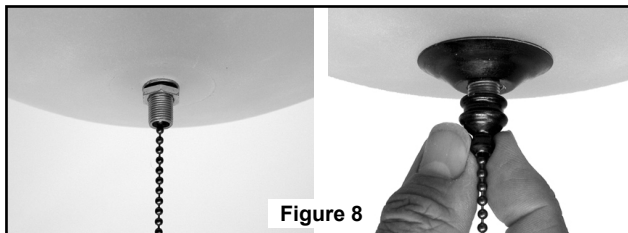

Figure 8



10983 Bennett Parkway
Zionsville, IN 46077
(888) 567-2055 • FAX (866) 482-5215
Visit Our Website @ fanimation.com