

# THE BAYHILL<sup>TM</sup>

## COLLECTION

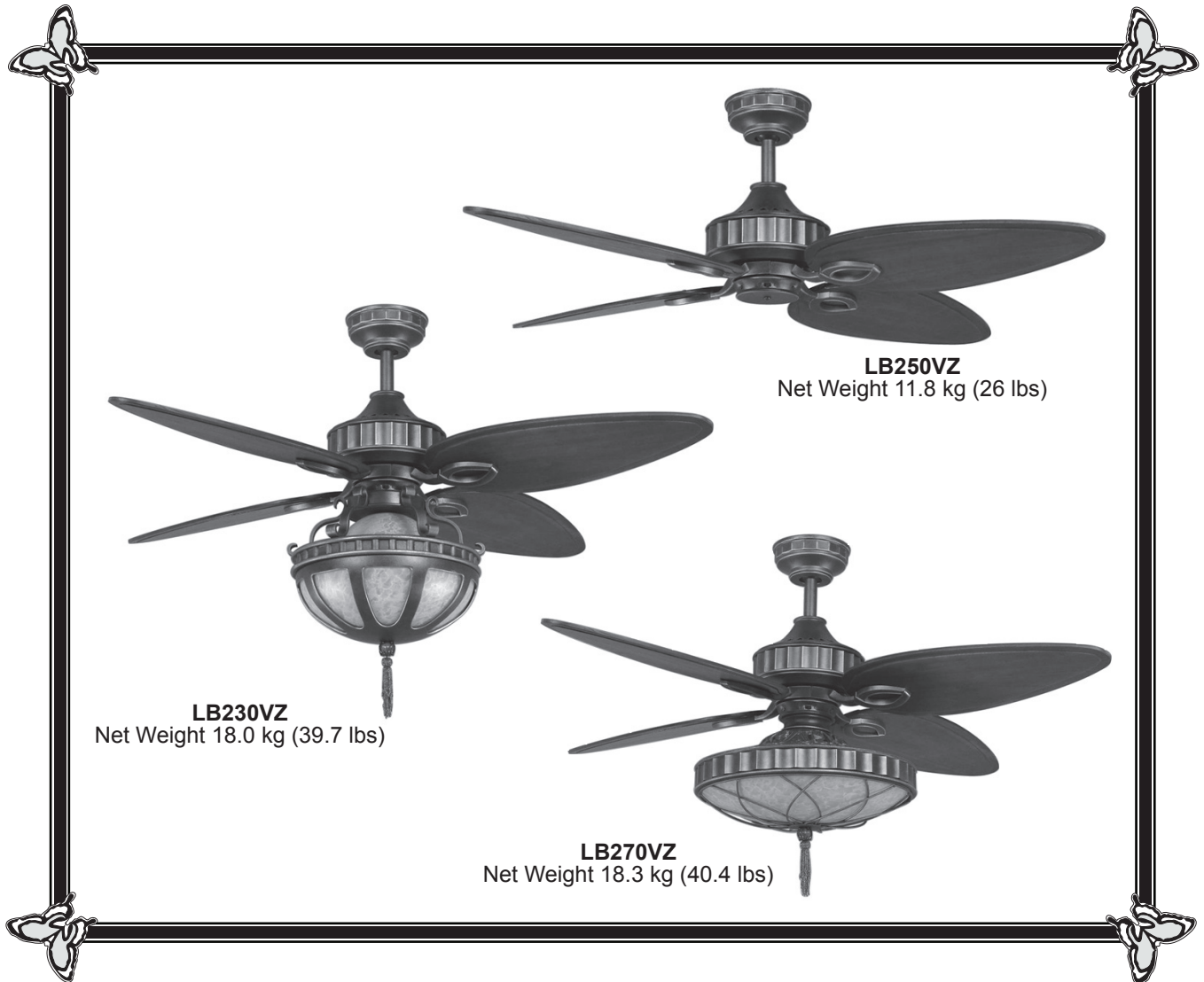

**MODELS No. LB250VZ, LB230VZ & LB270VZ**



# OWNER'S MANUAL

**READ AND SAVE THESE INSTRUCTIONS**

## Important Safety Instructions

**WARNING: To avoid fire, shock and serious personal injury, follow these instructions.**

1. Read your owner's manual and safety information before installing your new fan. Review the accompanying assembly diagrams.
2. Before servicing or cleaning unit, switch power off at service panel and lock service panel disconnecting means to prevent power from being switched on accidentally. When the service disconnecting means cannot be locked, securely fasten a warning device, such as a tag, to the service panel.
3. Be careful of the fan and blades when cleaning, painting, or working near the fan. Always turn off the power to the ceiling fan before servicing.
4. Do not insert anything into the fan blades while the fan is operating.
5. Do not operate reversing switch until fan blades have come to a complete stop.

## Additional Safety Instructions

1. To avoid possible shock, be sure electricity is turned off at the fuse box before wiring, and do not operate fan without blades.
2. All wiring and installation procedures must satisfy National Electrical Codes (ANSI/ NFPA 70-1999) and Local Codes. The ceiling fan must be grounded as a precaution against possible electrical shock. Electrical installation should be made or approved by a licensed electrician.
3. The fan base must be securely mounted and capable of reliably supporting at least 50 lbs. See page 4 of owner's manual for support requirements. Consult a qualified electrician if in doubt.
4. The fan must be mounted with the fan blades at least 7 feet from the floor to prevent accidental contact with the fan blades.
5. Follow the recommended instructions for the proper method of wiring your ceiling fan. If you do not have adequate electrical knowledge or experience, have your fan installed by licensed electrician.

**WARNING:** This product is designed to use only those parts supplied with this product and/or accessories designated specifically for use with this product. Using parts and/or accessories not designated for use with this product could result in personal injury or property damage.

**WARNING:** To reduce the risk of personal injury, do not bend the blade bracket (flange or blade holder) when installing the brackets, balancing the blades, or cleaning the fan. Do not insert foreign objects in between rotating fan blades.

## LIMITED LIFETIME WARRANTY

**Extends to the original purchaser of a Fanimation Fan**

1. LIMITED LIFETIME MOTOR WARRANTY - If any part of your fan motor fails, due to a defect in materials or workmanship during the lifetime of the original purchaser, Fanimation will provide the replacement part free of charge, when the defective fan is returned to our national service center. Proof of purchase is required. Customer shall be responsible for all costs incurred in the removal or reinstallation and shipping of the product for repairs or replacement.
2. ONE YEAR MOTOR LABOR WARRANTY - If your fan motor fails at any time within one year from the original purchase, due to defects in materials or workmanship, labor to repair the motor will be provided free of charge at our national service center. Purchaser will be responsible for labor charges after this one-year period. Customer shall be responsible for all costs incurred in the removal or reinstallation and shipping of the product for repairs or replacement.
3. If any other part of your fan fails at any time within one year after original purchase, due to a defect in materials or workmanship, we will repair, or replace, at our option, the defective part free of charge for parts and labor performed at our national service center.
4. Because of varying climate conditions, this warranty does not cover changes in the finish, including rusting, pitting, corroding, tarnishing, or peeling.
5. This warranty is void and does not apply to damage from improper installation, neglect, accident, misuse, exposure to extremes of heat or humidity, or as a result of any modification to the original product.
6. All costs of removal and reinstallation of the fan are the sole responsibility of the owner of the fan and not the store that sold the fan or Fanimation.
7. Fanimation reserves the right to modify or discontinue any product at any time and may substitute any part under this warranty.
8. Under no circumstances may a fan be returned without prior authorization from Fanimation. The receipt of purchase must accompany authorized returns and must be sent freight prepaid to Fanimation. The fan to be returned must be properly packed to avoid damage in transit; Fanimation will not be responsible for any damage resulting from improper packaging.
9. It is understood that any repair or replacement is the exclusive remedy available from Fanimation. There is no other expressed or implied warranty. Fanimation hereby disclaims any and all implied warranties, including, but not limited to those of merchantability and fitness for a particular purpose to the extent permitted by law. Some states do not allow limitations on implied warranties. Fanimation will not be liable for incidental, consequential, or special damages arising out of or in conjunction with product use or performance, except as may otherwise be accorded by law. This warranty gives you special legal rights and you may also have other rights that vary from state to state.
10. A certain amount of wobble is normal and should not be considered a problem or a defect.

## Table of Contents

Unpacking Instructions .....	3	Blade Cleaning .....	10
Electrical and Structural Requirements .....	4	Trouble Shooting .....	11
How to Assemble Your Ceiling Fan .....	4	Parts List – LB250VZ .....	12
How to Hang Your Ceiling Fan .....	6	Exploded-View Illustration – LB250VZ .....	13
How to Wire and Operate Your C27 Wall Control .....	7	Installation Instructions – LKLB230VZ .....	14
Installing the Canopy Housing .....	8	Service Parts – LKLB230VZ .....	15
Assembling and Mounting the Fan Blades, & Adapter/Switch Hsg ..	8	Installation Instructions – LKLB270VZ .....	16
Maintenance .....	10	Service Parts – LKLB270VZ .....	17

# This Manual is Designed to Make it as Easy as Possible for You to Assemble, Install, Operate, and Maintain Your Ceiling Fan

## Tools Needed for Assembly

- One Phillips head screwdriver
- One wire stripper
- One stepladder
- Three wire connectors (supplied)
- One ¼" blade screwdriver

### ⚠ WARNING

Before assembling your ceiling fan, refer to section on proper method of wiring your fan (page 7). If you feel you do not have enough wiring knowledge or experience, have your fan installed by a licensed electrician.

## Materials

Wiring outlet box and box connectors must be of type required by local code. The minimum wire would be a 3-conductor (2-wire with ground) of the following size:

<u>Installed Wire Length</u>	<u>Wire Size A.W.G.</u>
Up to 50 ft.	14
50 - 100 ft.	12

**NOTE:** Place the parts from the loose parts bags in a small container to keep them from being lost. If any parts are missing, contact your local retailer.

## Unpacking Instructions

For your convenience, check-off each step. As each step is completed, place a check mark. This will ensure that all steps have been completed and will be helpful in finding your place should you be interrupted.

### ⚠ WARNING

Do not install or use fan if any part is damaged or missing. This product is designed to use only those parts supplied with this product and/or any accessories designated specifically for use with this product by Fanimation. Substitution of parts or accessories not designated for use with this product by Fanimation could result in personal injury or property damage. Contact your retail store for missing or damaged parts.

1. Check to see that you have received the following parts:

**NOTE:** If you are uncertain of part description, refer to exploded view illustration. (Figure 1, page 13)

- Fan Motor assembly
- Motor Coupler Cover
- Housing Switch Cup/Adapter assembly
- Hanger Bracket with Shoulder Screws
- Downrod/Hanger Ball
- Ceiling Canopy
- Canopy Screw Cover assembly
- Blade Holder (4)
- Wood Blades (4)
- Hardware bags:
  - Nine ¼-20 x 14mm (blade holder to fan motor hub) screws
  - Thirteen ¾-16-24 x 15mm (blade to blade holder) pan-head screws, fiber & flat washers
  - Four wire connectors
  - Ceiling Support Cable with clamp
  - Flat washer
  - Lag bolt
  - Fanimation screwdriver

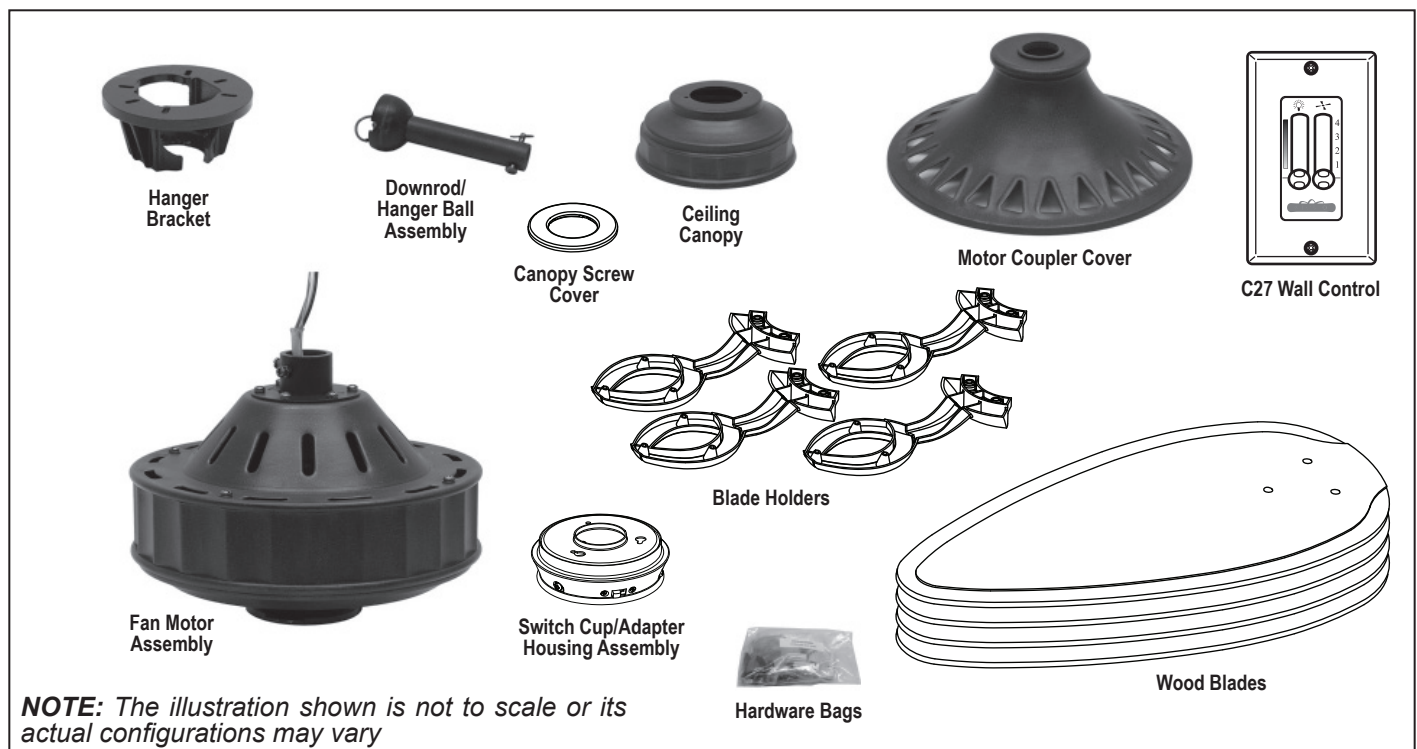

## Electrical and Structural Requirements

Your new ceiling fan will require a grounded electrical supply line of 120 volts AC, 60 Hz, 15 amp circuit. The outlet box must be securely anchored and capable of withstanding a load of at least 50 lbs. **Figure 1** depicts different structural configurations that may be used for mounting the outlet box.

### ⚠ WARNING

To reduce the risk of fire, electrical shock, or personal injury, mount fan to outlet box marked acceptable for fan support of 22.7 kg (50 lbs) or less. Use screws supplied with outlet box. Most outlet boxes commonly used for support of light fixtures are not acceptable for fan support and may need to be replaced. Consult a qualified electrician if in doubt.

If your fan is to replace an existing light fixture, turn electricity off at the main fuse box at this time and remove the existing light fixture.

### ⚠ WARNING

Turning off wall switch is not sufficient. To avoid possible electrical shock, be sure electricity is turned off at the main fuse box before wiring. All wiring must be in accordance with National and Local codes and the ceiling fan must be properly grounded as a precaution against possible electrical shock.

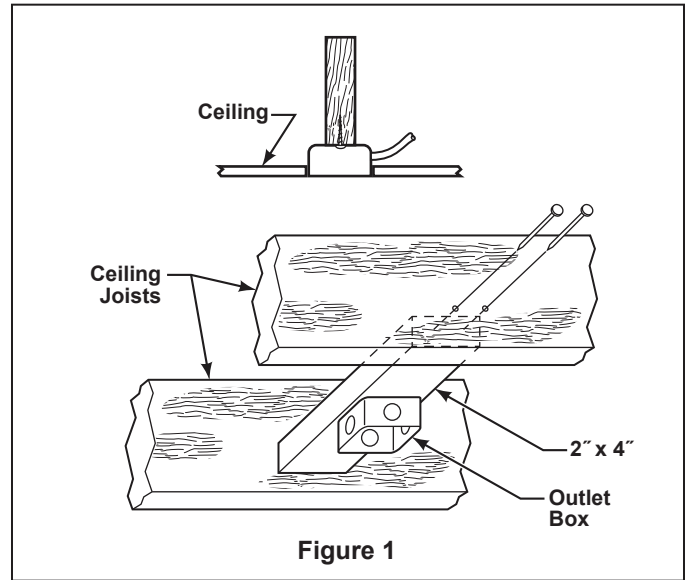

### ⚠ WARNING

To avoid fire or shock, follow all wiring instructions carefully. Any electrical work not described in these instructions should be done or approved by a licensed electrician.

## How to Assemble Your Ceiling Fan

1. Remove the Hanger Ball by loosening the setscrew in the Hanger Ball until the ball falls freely down the Downrod. (Figure 1) Remove the Pin from the Downrod, then remove the Hanger Ball. Retain the Pin and Hanger Ball for reinstallation in Step 5.

2. The fan comes with blue, black, and white 80" wires and support cable. Separate and untwist the three wires and support cable. Route the wires and cable through the Downrod.

**NOTE:** You will be using either the 6" downrod supplied with your fan or an optional downrod purchased separately.

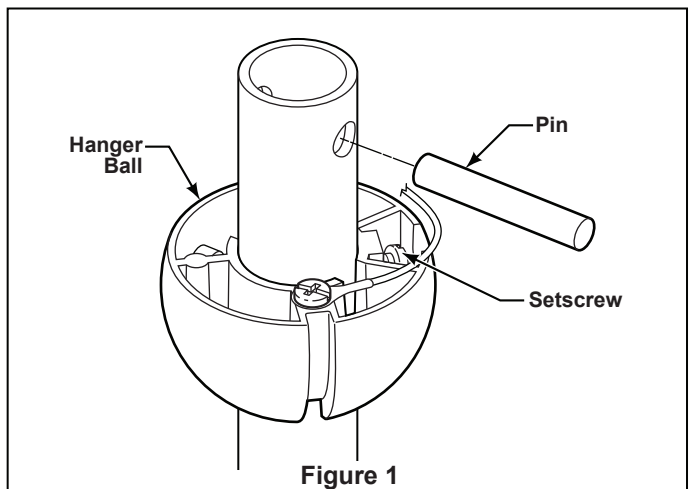

## How to Assemble Your Ceiling Fan (cont'd)

3. Loosen the two setscrews in the Downrod Support. Align the Clevis Pin holes in the Downrod with the holes in the Downrod Support. Install the Clevis Pin and secure with the Hairpin Clip. (Figure 2) Be sure to push the straight leg of the hairpin clip through the hole near the end of the clevis pin until the curved portion of the hairpin clip snaps around the clevis pin. The hairpin clip must be properly installed to prevent the clevis pin from working loose. Pull on the Downrod to make sure the clevis pin is properly installed.

4. While pulling up on the Downrod, securely tighten the two 3/16-24 x 3/8" setscrews in the downrod support. (Figure 3)

5. Route wires through opening in Motor Coupler Cover and Canopy. Position Canopy on fan shown with open side facing up. (Figure 3)

6. Reinstall the Hanger Ball (Figure 1) on the Downrod as follows. Route the three 80" wires and support cable through the Hanger Ball. Position the Pin through the two holes in the Downrod and align the Hanger Ball so the Pin is captured in the groove in the top of the Hanger Ball. Pull the Hanger Ball up tight against the pin. **Securely tighten the setscrew in the Hanger Ball.** A loose setscrew could create fan wobble.

### **⚠ WARNING**

It is critical that the clevis pin in the downrod support is properly installed and the setscrews are securely tightened. Failure to verify that the pin and setscrews are properly installed could result in the fan falling.

**NOTE:** The setscrews must be properly installed as described above, or fan-wobble could result.

7. The fan comes with blue, black, and white leads. Before installing fan, measure up approximately 6-9 inches above top of Downrod/Hanger Ball Assembly. Cut off excess wire and strip back insulation 1/2" from end of wire.

8. You have now completed the upper assembly of your new ceiling fan. You can now proceed with the hanging and the electrical wiring of your fan.

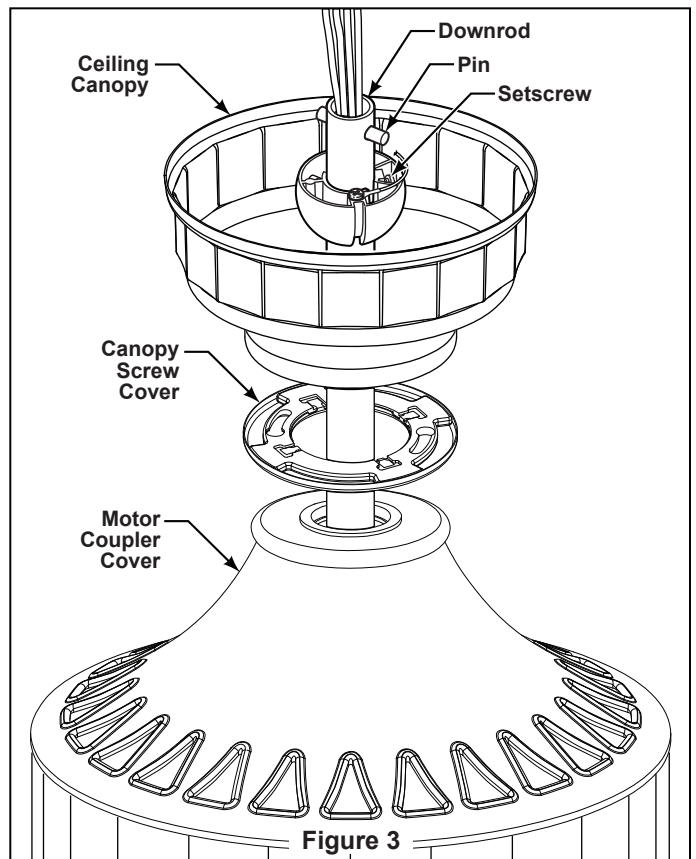
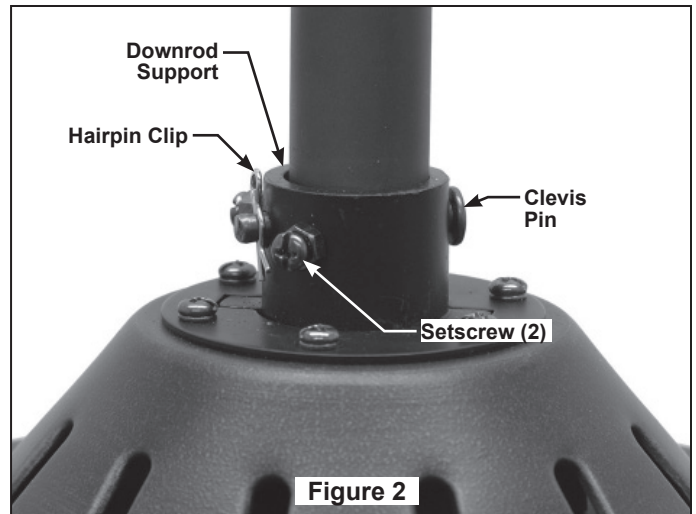



# How to Hang Your Ceiling Fan

## ⚠ WARNING

To avoid possible electrical shock, be sure electricity is turned off at the main fuse box before hanging.  
**NOTE:** If you are not sure if the outlet box is grounded, contact a licensed electrician for advice, as it must be grounded for safe operation.

## ⚠ WARNING

The fan must be hung with at least 7' of clearance from floor to blades (Figure 1)

## ⚠ WARNING

The outlet box must be securely anchored and capable of withstanding a load of at least 50 lbs. Hanger bracket must seat firmly against outlet box. If the outlet box is recessed, remove wallboard until bracket contacts box. If bracket and/or outlet box are not securely attached, the fan could wobble or fall.

## CAUTION

Do not connect fan blades until the fan is completely installed. Hanging fan with blades connected may result in damage to the fan blades.

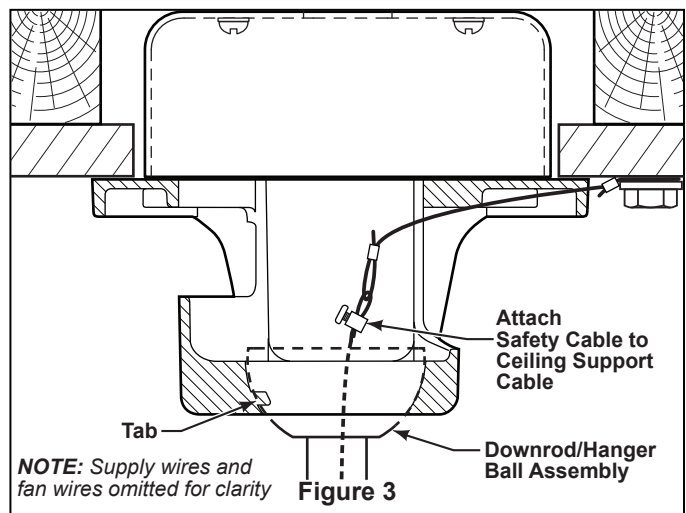
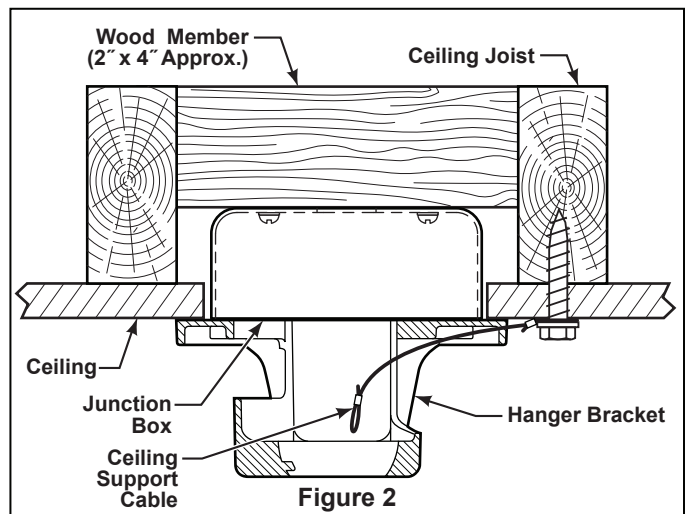
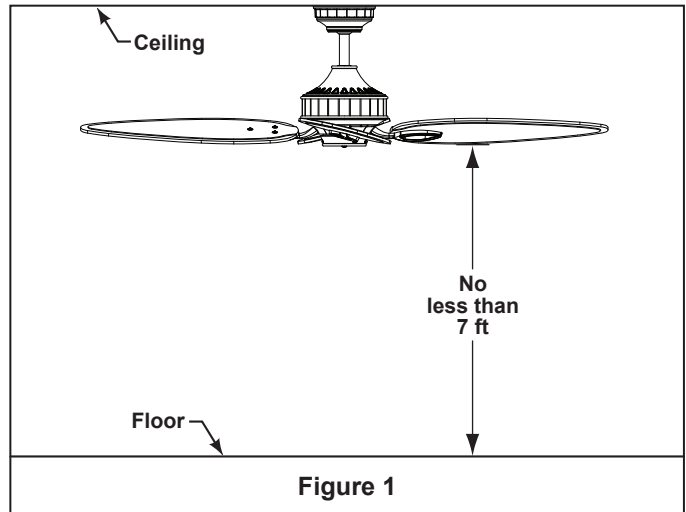

1. Using the  $\frac{3}{8}$ " x 2" lag bolt and flat washer, attach safety cable to ceiling joist or wood structural member. The lag bolt will pass through the flat washer, safety cable loop, and into the building structure (Figure 2). You will first drill a  $\frac{1}{4}$ " pilot hole into the building structure to prevent splitting or cracking.

2. Securely attach the hanger bracket to ceiling junction box **acceptable for ceiling support**.

**NOTE:** Ceiling support cable cannot be secured to junction box only, it must be directly secured to ceiling joist or structural member using the  $\frac{3}{8}$ " x 2" lag bolt and flat washer. (Figure 2)

3. Make sure the electrical supply wires, including the hanger bracket grounding wire and safety cable are pulled through the downrod, between the hanger bracket and the junction box so that electrical connections can be made later.

4. Carefully lift the fan and seat the downrod/hanger ball assembly on the hanger bracket that was just attached to the ceiling joist. Be sure the groove in the ball is lined up with tab on the hanger bracket. (Figure 3)

5. Attach the safety cable to ceiling support cable. Slide cable clamp onto safety cable (from fan). Place the end of cable through the loop of ceiling support cable. Pull as much cable through loop as possible. Feed end of cable into clamp hole and firmly tighten screw (Figure 3). Cut off excess safety cable.

## ⚠ WARNING

Failure to seat tab in groove could cause damage to electrical wires and possible shock or fire hazard.

## ⚠ WARNING

To avoid possible shock, do not pinch wires between the downrod/hanger ball assembly and the hanger bracket.

# How to Wire and Operate Your C27 Wall Control

*If you feel that you do not have enough electrical wiring knowledge or experience, have your fan installed by a licensed electrician.*

## ⚠ WARNING

To avoid possible electrical shock, be sure electricity is turned off at the main fuse box before wiring.

**NOTE:** If you are not sure if the outlet box is grounded, contact a licensed electrician for advice, as it must be grounded for safe operation.

### 1. Installing Wall Control (Figures 1 & 2):

- With electrical power still disconnected, remove the existing wall plate and switch.
- Make wiring connections with wire nuts as shown in Figure 1.
  - One black/white wire from wall control unit to black wire (hot supply).
  - One blue wire from wall control unit to blue wire (light).
  - One black wire from wall control unit to black wire leading to ceiling outlet box.
- Attach wall control unit to outlet box using the two 6-32 screws provided.
- Attach wall plate to the switch control front using the two small screws provided.
- Restore electrical power.

## ⚠ WARNING

To avoid possible fire or shock, make sure that the electrical wires are completely inside the outlet box and not pinched between the wall plate and the wall.

## ⚠ WARNING

Check to see that all connections are tight, including ground, and that no bare wire is visible at the wire connectors, except for the ground wire. Do not operate fan until the blades are in place. Noise and fan damage could result.

### 2. Operating & Using Wall Control (Figure 3):

**NOTE:** If airflow is desired in the opposite direction, turn the fan off and wait for the blades to stop turning. Then slide the reverse switch to the opposite position and turn fan on again. The reversing switch is located on side of the switch cup.

#### Fan Switch

- 4 Slide Switch – low fan speed
- 3 Slide Switch – low-medium fan speed
- 2 Slide Switch – medium fan speed
- 1 Slide Switch – high fan speed
- \_ Switch – fan off

#### Light Switch

- Dimmer Slide Switch – low to bright light
- \_ Switch – light off

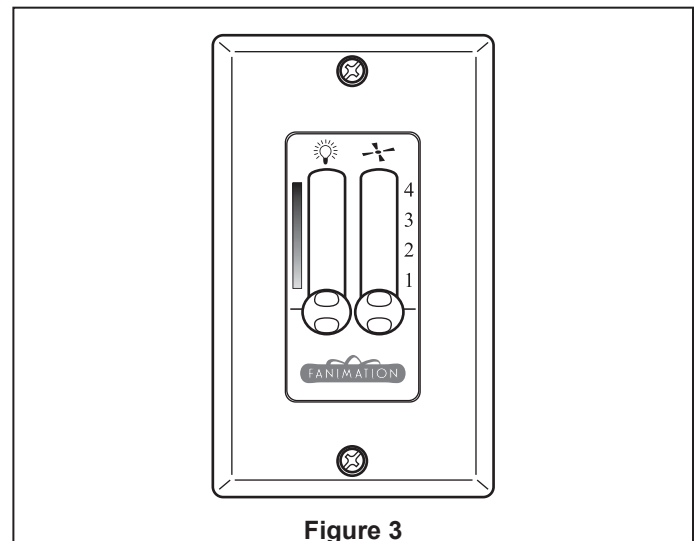
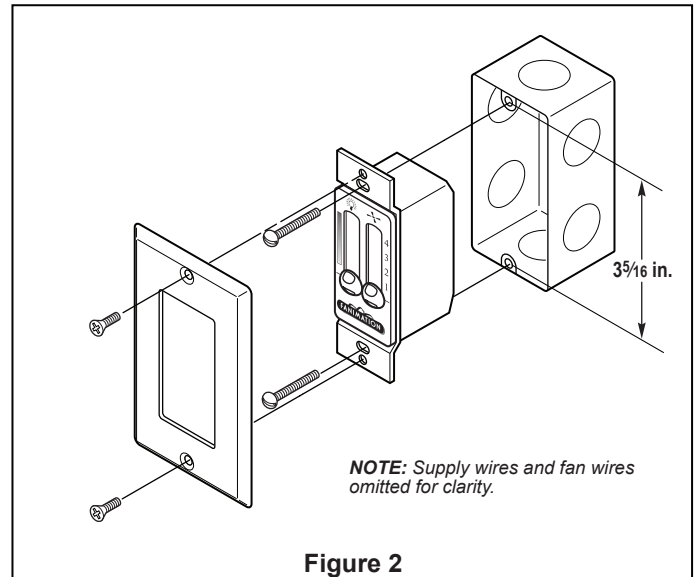
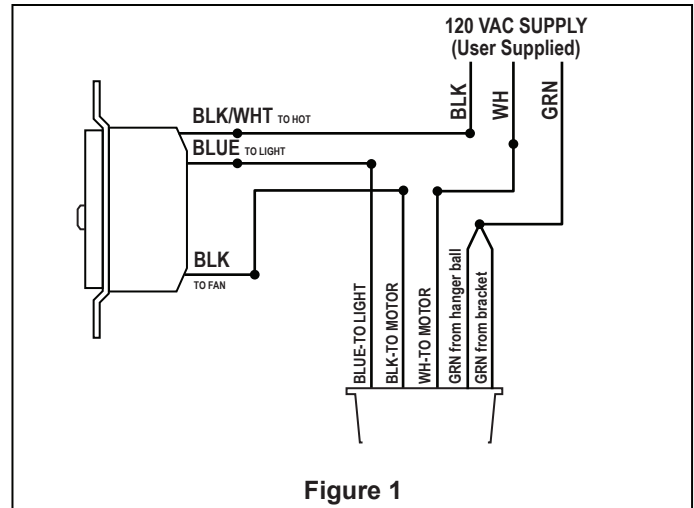

## Installing the Canopy Housing

**NOTE:** This step is applicable **after** the necessary wiring is completed.

### **⚠ WARNING**

To avoid possible fire or shock, make sure that the electrical wires are completely inside the canopy housing and not pinched between the housing and the ceiling.

1. Loosen the two shoulder screws in the Hanger Bracket (Figure 1a).
2. Securely attach the Canopy Housing over the shoulder screws.
3. Securely attach and tighten the Canopy Screw Cover over the shoulder screws in the Hanger Bracket utilizing the keyslot twist-lock feature (Figure 1b).

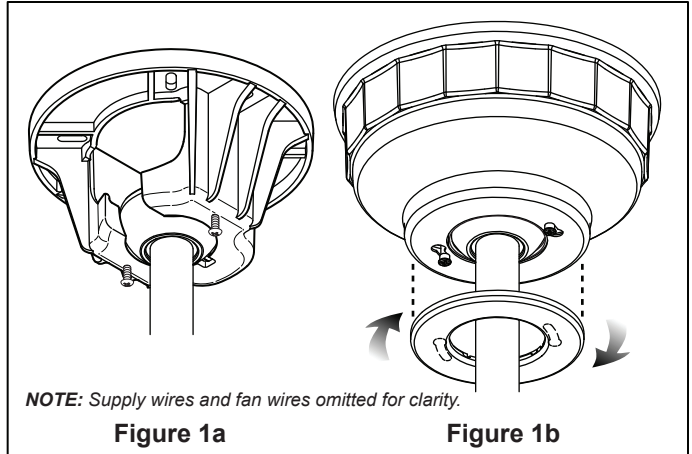

## Assembling and Mounting the Fan Blades, & Adapter/Switch Hsg

### **INSTALLATION NOTE**

*Do not connect fan blades until the fan is completely installed. Installing the fan with blades assembled may result in damage to the fan blades.*

### **⚠ WARNING**

To reduce the risk of personal injury, do not bend the blade holders when installing, balancing the blades or cleaning the fan. Do not insert foreign objects in between the rotating blades.

1. Remove and discard the (rubber) motor “stops” by removing the four screws. (Figure 1)

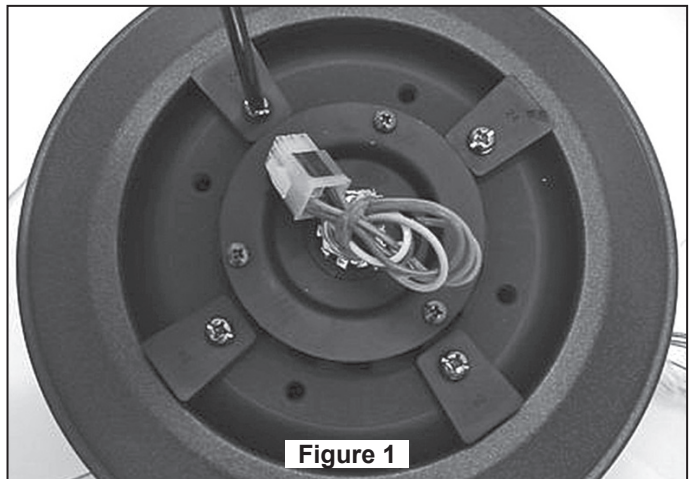

#### **Blade & Blade Holder Assembly:**

2. Lay the side of the blade holder on a flat surface with the inside of the blade holder facing up. This is the side with the threaded posts.
3. Position the wood blade over the blade holder with the threaded posts showing. Make sure the bottom edge of the blade is fully seated against the blade holder.
4. With a Phillips screwdriver, tighten pan-head screws with fiber washers and flat washers to secure the blade. (Figure 2)

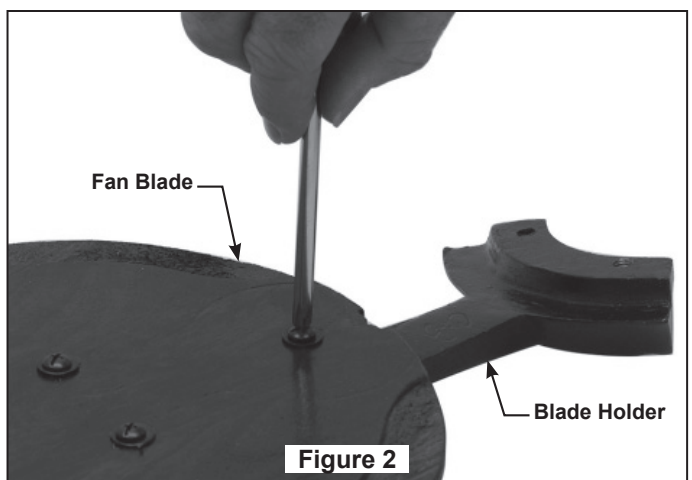



## Assembling and Mounting the Fan Blades, & Adapter/Switch Hsg

5. Attach assembled blades and blade holders to the motor hub using the provided screws. (Figure 3)

6. Make sure the screws securing the blade holders to the motor hub are tight and that the blade holders are properly seated.

**NOTE:** Supply wires and fan wires omitted for clarity.

### Housing Switch Cup/Adapter Assembly:

7. Disassemble the Housing Switch Cup/Adapter assembly by removing three screws.

8. Assemble the Adapter assembly on the Housing Support bracket and tighten three screws. (Figure 4)

9. Securely attach the 9-pin switch cup connector to wiring harness socket within Adapter assembly.

10. Assemble the Housing Switch Cup onto the assembled Adapter with three screws. (Figure 5)

11. Restore Power and your fan is now wired to be turned on and off from the wall control.

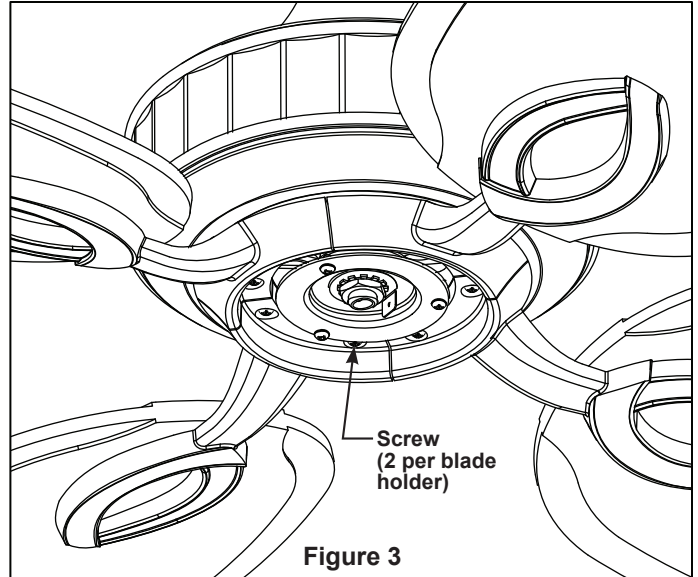

Figure 3

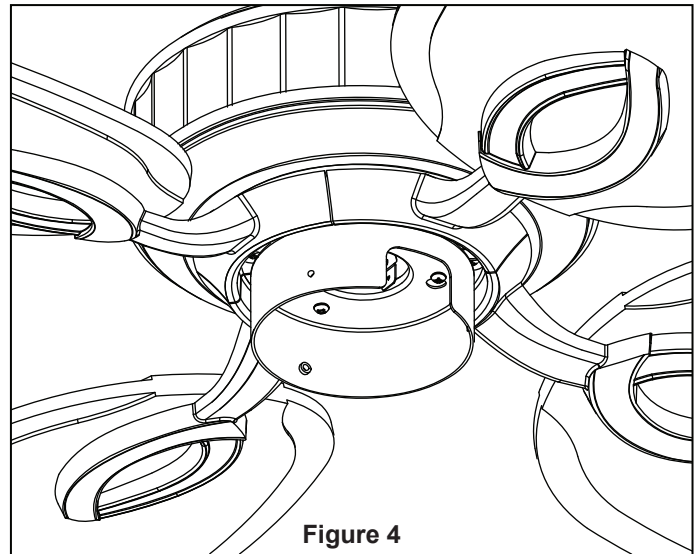

Figure 4

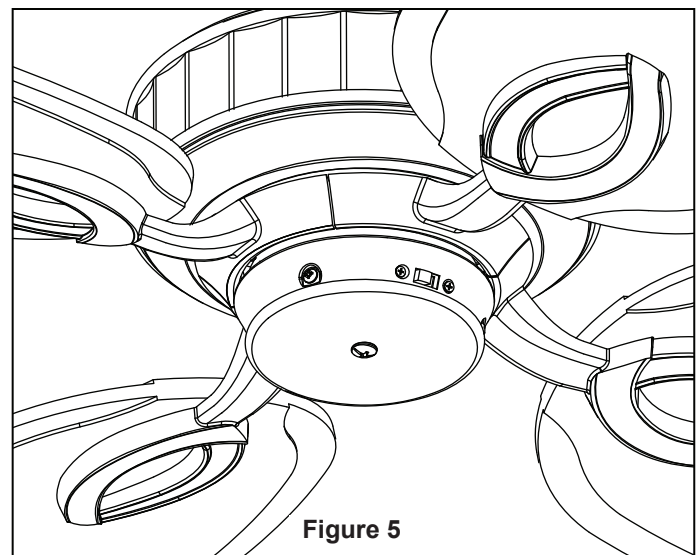

Figure 5

---

## Maintenance

Periodic cleaning of your ceiling fan is the only maintenance that is needed.

When cleaning, use only a soft brush or lint free cloth to avoid scratching the finish.

Abrasive cleaning agents are not required and should be avoided to prevent damage to finish.

<b>CAUTION</b>
----------------

<b>Do not use water when cleaning your ceiling fan. It could damage the motor or the blades and create the possibility of electrical shock.</b>
---

---

## Blade Cleaning

Periodic light dusting of the Wood blades is recommended. A feather duster will work best.

Avoid using water, cleansers, or harsh rags, which can warp and ruin the blades.

# Trouble Shooting

## **WARNING**

For your own safety turn off power at fuse box or circuit breaker before trouble shooting your fan.

Trouble	Probable Cause	Suggested Remedy
<b>1. FAN WILL NOT START</b>	<ol style="list-style-type: none"> <li>1. Fuse or circuit breaker blown.</li> <li>2. Loose power line connections to the fan, or loose switch wire connections in the switch housing.</li> <li>3. Reversing switch in neutral position.</li> </ol>	<ol style="list-style-type: none"> <li>1. Check main and branch circuit fuses or circuit breakers.</li> <li>2. Check line wire connections to fan and switch wire connections in the switch housings.</li> </ol> <p><b>CAUTION: Make sure main power is turned off !</b></p> <ol style="list-style-type: none"> <li>3. Make sure reversing switch position is all the way to one side.</li> </ol>
<b>2. FAN SOUNDS NOISY</b>	<ol style="list-style-type: none"> <li>1. Blades not attached to fan.</li> <li>2. Loose screws in motor housing.</li> <li>3. Screws securing fan blade holders to motor flywheel are loose.</li> <li>4. Wire connectors inside housing rattling.</li> <li>5. Motor noise caused by solid state variable speed control.</li> <li>6. Screws holding blades to blade holders are loose.</li> <li>7. Lower housing support set screw loose.</li> </ol>	<ol style="list-style-type: none"> <li>1. Attach blades to fan before operating.</li> <li>2. Check to make sure all screws in motor housing are snug (not over-tight).</li> <li>3. Check to make sure the screws which attach the fan blade holders to the motor flywheel are tight.</li> <li>4. Check to make sure wire connectors in switch housing are not rattling against each other or against the interior wall of the switch housing.</li> </ol> <p><b>CAUTION: Make sure main power is turned off !</b></p> <ol style="list-style-type: none"> <li>5. Some fan motors are sensitive to signals from solid-state variable speed controls. Solid-state controls are not recommended, choose an alternative control method.</li> <li>6. Tighten screws securely.</li> <li>7. Tighten set screw securely.</li> </ol>
<b>3. FAN WOBBLES EXCESSIVELY</b>	<ol style="list-style-type: none"> <li>1. Setscrew in downrod support is loose.</li> <li>2. Setscrew in downrod/hanger ball assembly is loose.</li> <li>3. Screws securing fan blade holders to motor hub are loose.</li> <li>4. Blade holders not seated properly.</li> <li>5. Hanger bracket and/or ceiling outlet box is not securely fastened.</li> <li>6. Fan blades out of balance.</li> </ol>	<ol style="list-style-type: none"> <li>1. Tighten both setscrews securely in downrod support.</li> <li>2. Tighten the setscrew in the downrod/hanger ball assembly.</li> <li>3. Check to be sure screws which attach the fan blade holders to the flywheel are tight.</li> <li>4. Check to be sure the fan blade holders seat firmly and uniformly to the surface of the motor housing. If holders are seated incorrectly, loosen the screws and retighten.</li> <li>5. Tighten the hanger bracket screws to the outlet box, and secure outlet box.</li> <li>6. Interchanging position of fan blades can redistribute the weight and result in a smoother operation. For example, exchange blades in positions 1 and 3 or 1 and 4. If this does not improve wobble, exchange 2 and 3 or 2 and 4.</li> </ol>
<b>4. NOT ENOUGH AIR MOVEMENT</b>		<ol style="list-style-type: none"> <li>1. If possible, consider using a longer downrod. For example, use a 12" downrod instead of the 6" downrod that comes with your fan.</li> </ol>

# Parts List

Model #LB250VZ

Ref. #	Description	Part #
1	Hanger Bracket Assembly with Shoulder Screws (2)	AP255
2	<i>Downrod/Hanger Ball Assembly Containing:</i>	ADR1-6VZ
2a	Hanger Ball Assembly	
2b	Downrod	
2c	Hairpin Clip	
2d	Clevis Pin	
3	Ceiling Canopy	P268VZ
4	Canopy Screw Cover	AP260VZ
5	Motor Coupler Cover	AP245VZ
6	Fan Motor Assembly	AMA200VZ
7	Housing Switch Cup/Adapter Assembly	AP275VZ
8	<i>Support Cable Bag Containing:</i>	HWBSCABLE
	Ceiling Support Cable	
	Cable Clamp	
	Flat Washer	
	Lag Bolt, $\frac{3}{8}$ " x 2"	
	<i>Hardware Bag Containing:</i>	HDWLB250
	Wire Connectors (4)	
	<i>Blade Holder Mounting Hardware Bag Containing:</i>	HDWBH250
	$\frac{1}{4}$ -20 x 14 mm Phillips Screws (11)	
	<i>Blade Mounting Hardware Bag Containing:</i>	HDWBM250
	Phillips Pan-Head Screws, $\frac{3}{16}$ -24 x 14 mm, Fiber Washers (13), & Flat Washers (13)	
	Phillips Screwdriver, 4"	
9	Blade Holder - (Set of 4)	AP230VZ
10	Wood Blades (Set of 4)	AP255CP
11	Wall Control	C27

**Before discarding packaging materials, be certain all parts have been removed**

## How To Order Parts

When ordering repair parts, always give the following information:

- Part Number
- Part Description
- Fan Model Number

Contact your retail store for repair parts.

# The Bayhill Collection™ LB250VZ

## Exploded-View

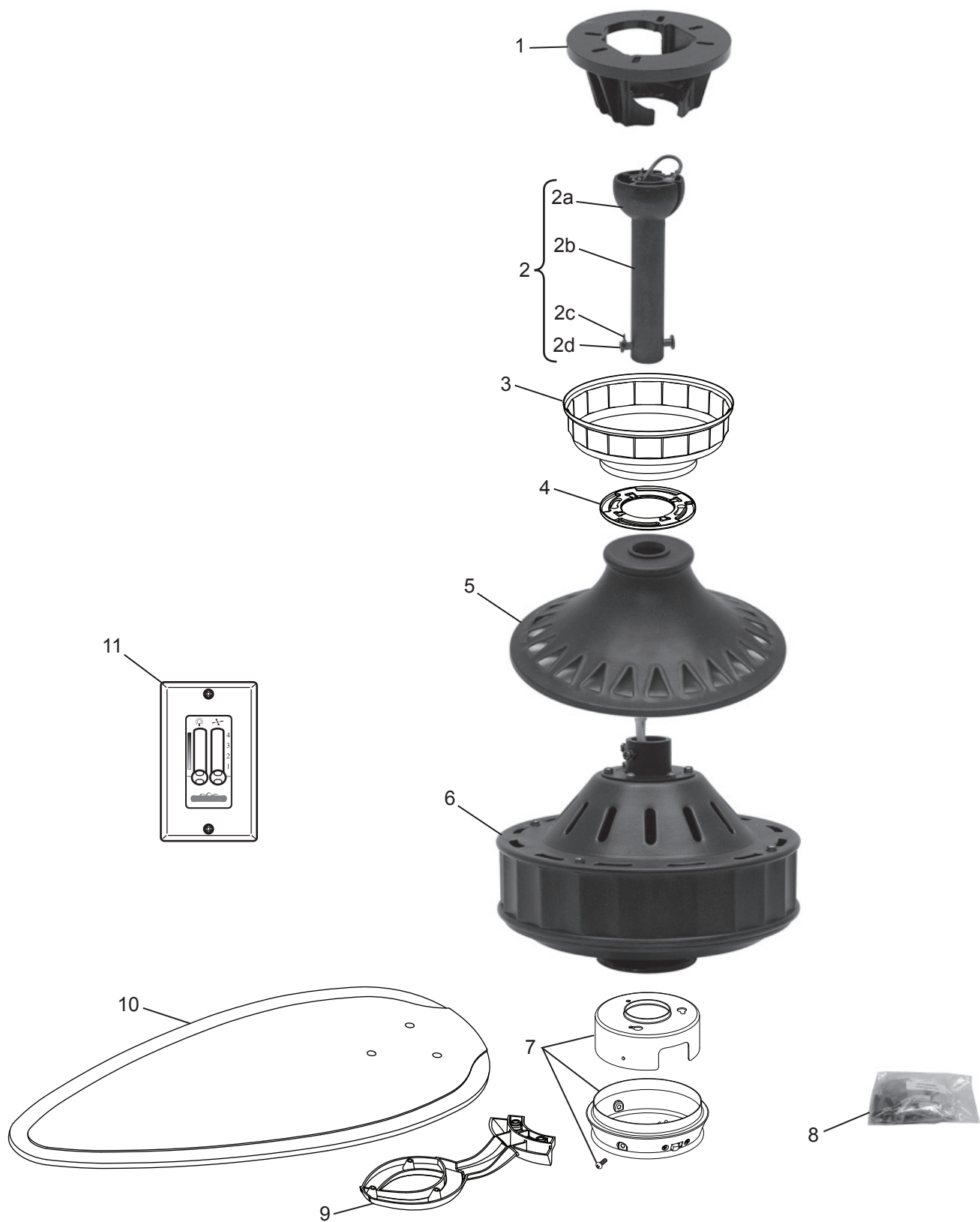

Figure 1

**NOTE:** The illustration shown is not to scale or its actual configuration may vary



# LKLB230VZ Ceiling Fan Light Kit Installation Instructions

## READ AND SAVE THESE INSTRUCTIONS

Weight: 9.5 lbs (4.31 kgs)

**NOTE:** Ceiling fan light kits are only meant to be used with ceiling fans. Do NOT install as a light fixture.

**WARNING:** To reduce the risk of fire or electric shock, do not use this fan/light kit with any solid-state speed control device.

### CAUTION

Turning off wall switch is not sufficient. To reduce the risk of fire and electrical shock, be sure electricity is turned off at the main fuse box to the fan before installing the light kit.

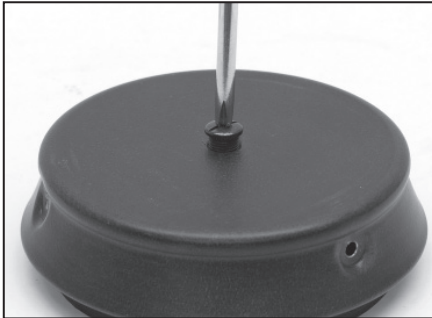

1. Remove threaded plug from switch cup housing.

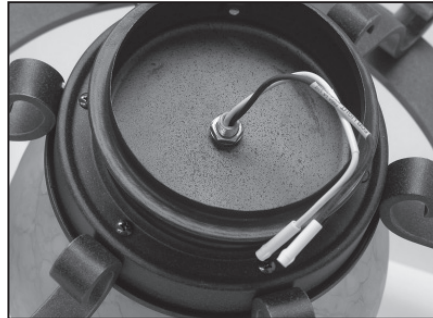

2. Assemble light kit and switch cup housing with lockwasher and nut provided.



3. Connect white-to-white and blue-to-black wires.



4. Assemble switch cup housing/light kit assembly with original screws.



5. Install 3 candelabra bulbs (not included - 40 watts max) in each of the sockets.

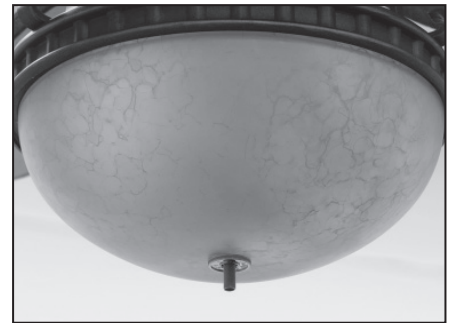

6. Assemble glass bowl with rubber washer/ knurled nut provided, do not over-tighten.



7. Assemble glass frame with tassel fob provided, do not over-tighten.

### ⚠ WARNING

To avoid possible fire or shock, make sure that the electrical wires are completely inside the fan housing and not pinched between the switch cup housing and the switch cup flange.

## LKLB230VZ Ceiling Fan Light Kit Service Parts



Lauren Brooks® – Bayhill™ Fan – Model #LB230VZ		
Ref #	Description	Part #
1	Dual-Bowl Assembly	AP23000VZ
2	Lower Glass	P23080
3	Knurled Nut w/Rubber Washer	AP25010
4	Lower Glass Frame	AP23070VZ
5	Tassel Fob	AP27015

**Before discarding packaging materials, be certain all parts have been removed**

### How To Order Parts

When ordering repair parts, always give the following information:

- Part Number
- Part Description
- Fan Model Number

Contact your retail store for repair parts.

# LKLB270VZ Ceiling Fan Light Kit Installation Instructions

## READ AND SAVE THESE INSTRUCTIONS

Weight: 7.75 lbs (3.52 kgs)

**NOTE:** Ceiling fan light kits are only meant to be used with ceiling fans. Do NOT install as a light fixture.

**WARNING:** To reduce the risk of fire or electric shock, do not use this fan/light kit with any solid-state speed control device.

### CAUTION

Turning off wall switch is not sufficient. To reduce the risk of fire and electrical shock, be sure electricity is turned off at the main fuse box to the fan before installing the light kit.

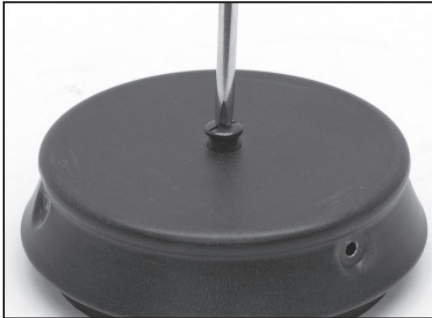

1. Remove threaded plug from switch cup housing.



2. Assemble light kit and switch cup housing with lockwasher and nut provided.

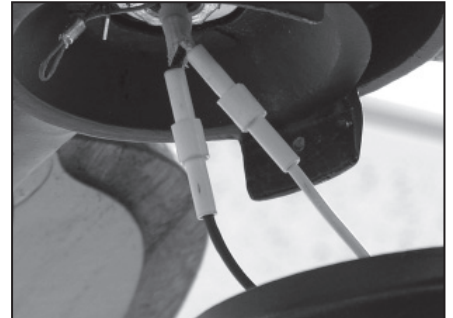

3. Connect white-to-white and blue-to-black wires.



4. Assemble switch cup housing/light kit assembly with original screws.

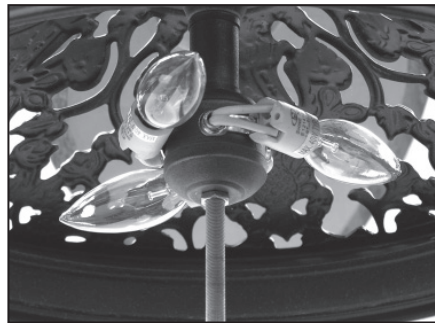

5. Install 3 candelabra bulbs (not included - 40 watts max) in each of the sockets.



6. Assemble glass bowl with rubber washer/knurled nut provided, do not over-tighten.



7. Assemble glass frame with tassel fob provided, do not over-tighten.

### ⚠ WARNING

To avoid possible fire or shock, make sure that the electrical wires are completely inside the fan housing and not pinched between the switch cup housing and the switch cup flange.

## LKLB270VZ Ceiling Fan Light Kit Service Parts

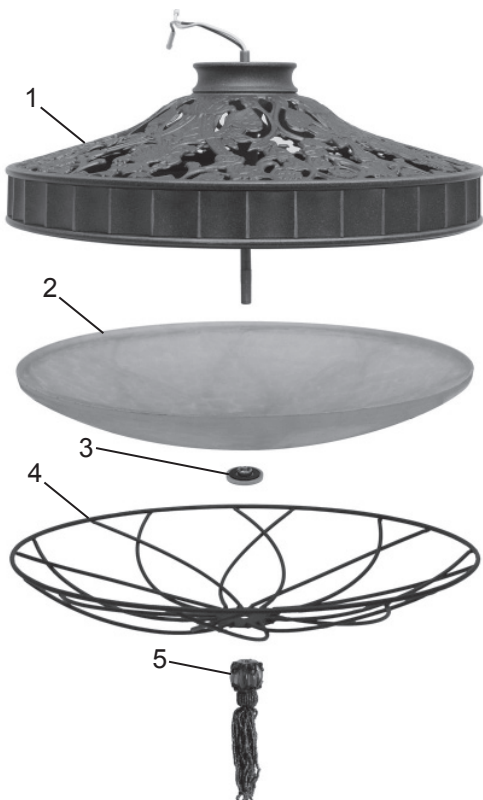

Lauren Brooks® – Bayhill™ Fan – Model #LB270VZ		
Ref #	Description	Part #
1	Filigree Bowl Assembly	AP27000VZ
2	Lower Glass	P27060
3	Knurled Nut w/Rubber Washer	AP25010
4	Lower Glass Frame	AP27050VZ
5	Tassel Fob	AP27015

**Before discarding packaging materials, be certain all parts have been removed**

### How To Order Parts

When ordering repair parts, always give the following information:

- Part Number
- Part Description
- Fan Model Number

Contact your retail store for repair parts.



**10983 Bennett Parkway  
Zionsville, IN 46077  
(888) 567-2055**

**FAX (866) 482-5215**

**Outside U.S. call (317) 733-4113**

**Visit Our Website @ [www.fanimation.com](http://www.fanimation.com)**

*Copyright 2007 Fanimation*

*2007/02*

*Lauren Brooks™ & Lauren Brooks Collection™ are trademarks of Lauren Brooks, Inc.*